

Highways Act 1980 sec.119 - Proposed Diversion of Kingston Lisle Footpath No.4 (part) & Sparsholt Footpath No.6 (part)

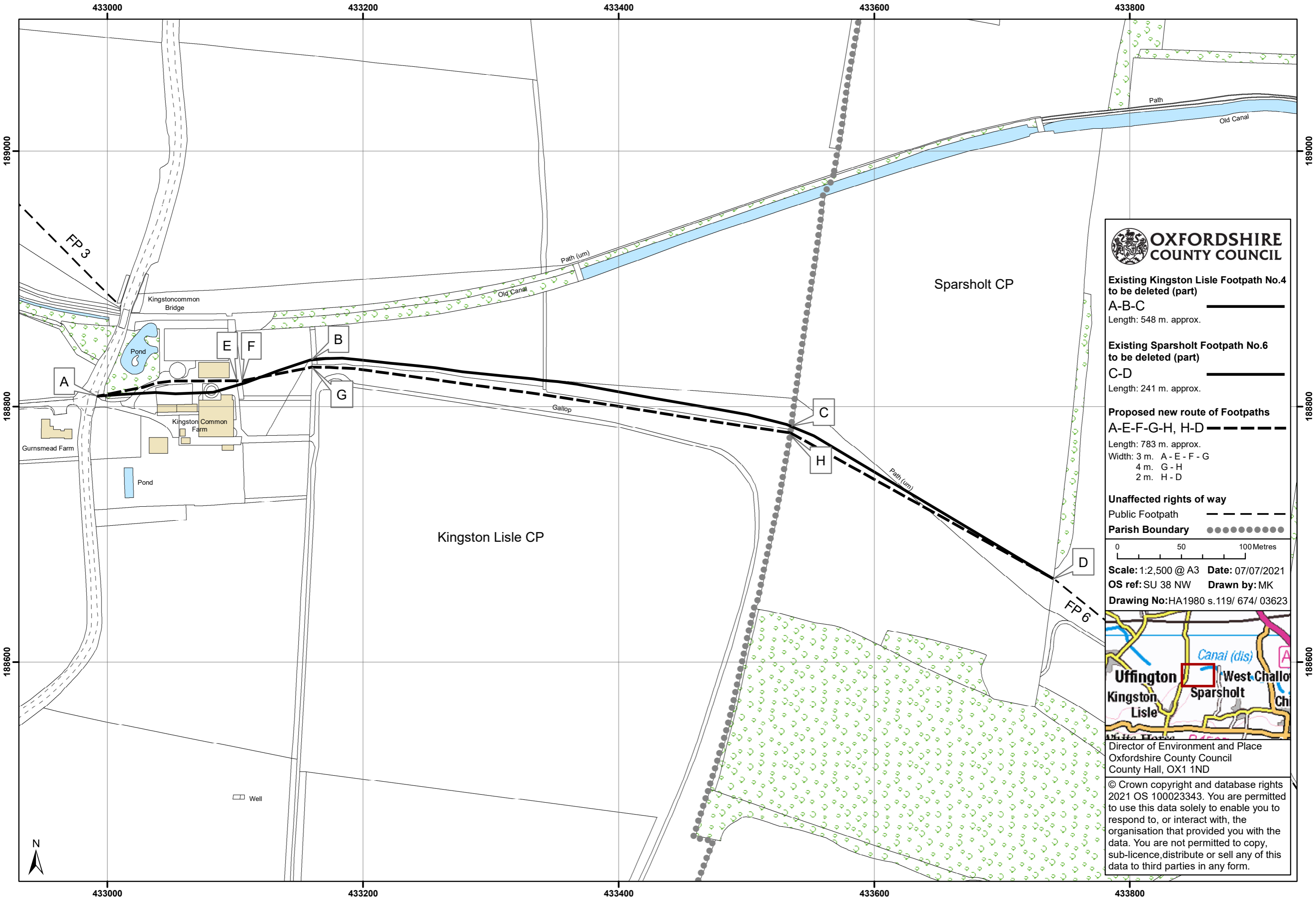

Existing Kingston Lisle Footpath No.4 to be deleted (part)

A-B-C
Length: 548 m. approx.

Existing Sparsholt Footpath No.6 to be deleted (part)

C-D
Length: 241 m. approx.

Proposed new route of Footpaths

A-E-F-G-H, H-D
Length: 783 m. approx.
Width: 3 m. A - E - F - G
4 m. G - H
2 m. H - D

Unaffected rights of way

Public Footpath
Parish Boundary

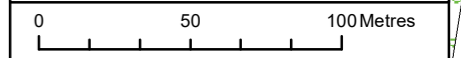

Scale: 1:2,500 @ A3 Date: 07/07/2021

OS ref: SU 38 NW Drawn by: MK

Drawing No: HA1980 s.119/ 674/ 03623

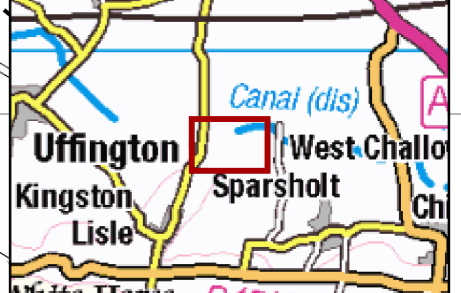

Director of Environment and Place
Oxfordshire County Council
County Hall, OX1 1ND

© Crown copyright and database rights 2021 OS 100023343. You are permitted to use this data solely to enable you to respond to, or interact with, the organisation that provided you with the data. You are not permitted to copy, sub-licence, distribute or sell any of this data to third parties in any form.