

P:\4. Improvement Schemes\Schemes\201320 Connections to Oxford Station\201320 Part 2 Feb 2017\07 Drawings\05 Working Drgs\201320-CON-000-004 (PES).dwg

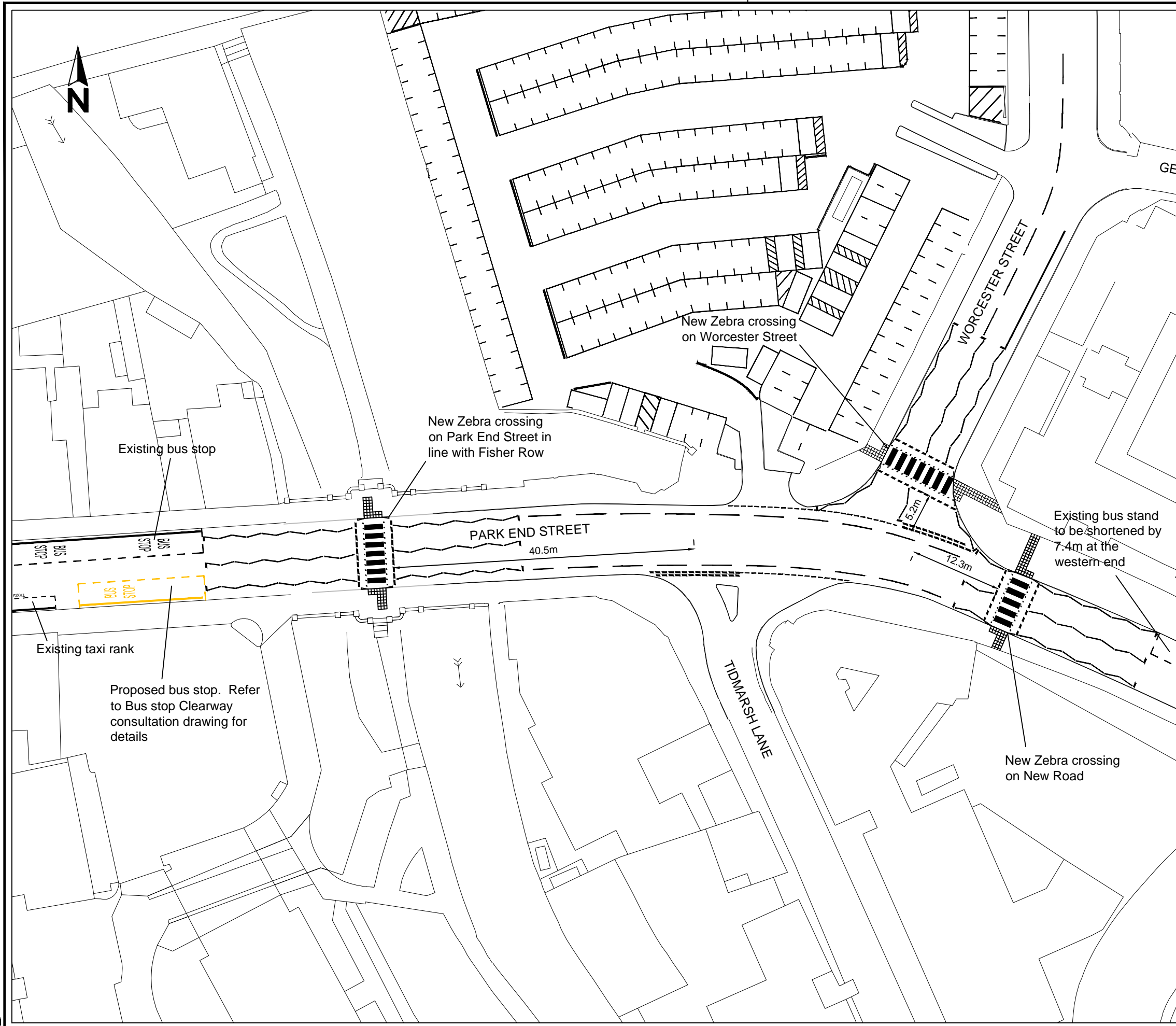

Drawing No. 201320/CON/000/004 Revision 0

NOTES

- Existing traffic signal control to be removed as part of the permanent changes to the junction layout..

SAFETY, HEALTH AND ENVIRONMENTAL INFORMATION

IN ADDITION TO THE HAZARDS/RISKS NORMALLY ASSOCIATED WITH THE TYPES OF WORK DETAILED ON THIS DRAWING, NOTE THE FOLLOWING SIGNIFICANT RESIDUAL RISKS

CONSTRUCTION	None - feasibility review stage only
MAINTENANCE/CLEANING	None - feasibility review stage only
USE	None - feasibility review stage only
DECOMMISSIONING/DEMOLITION	None - feasibility review stage only

© Crown Copyright and Database rights 10023343 2017

Rev.	Date	Purpose of revision	Drawn	Checked	Approved

OXFORDSHIRE COUNTY COUNCIL
 Owen Jenkins
 Director for Infrastructure Delivery
 Communities
 Oxfordshire County Council
 County Hall
 New Road
 Oxford
 OX1 1ND
 Tel: 0845 310 1111

Project title
Connections to Oxford Station

Drawing title
**Park End St / New Rd / Worcester St
 Proposed Zebra Crossings**

Drawing Status		Consultation	
Scale @ A3	Drawn by SAC	Checked by EA	Approved by EA
1:500	Date drawn 04.05.2017	Date checked 05.05.2017	Date approved 05.05.2017

Oxfordshire Project No. & File Ref

Drawing No. 201320/CON/000/004 Revision 0